



Board of Adjustment Staff Report

Meeting Date: June 2, 2022

Agenda Item: 8D

ADMINISTRATIVE CASE NUMBER:

WADMIN22-0010 (Classical Tahoe)

BRIEF SUMMARY OF REQUEST:

An administrative permit and approval of an outdoor community event business license application with associated conditions for Classical Tahoe

STAFF PLANNER:

Chris Bronczyk, Senior Planner
Phone Number: 775.328.3612
E-mail: cbronczyk@washoecounty.gov

CASE DESCRIPTION

For hearing, discussion, and possible action to approve an administrative permit and outdoor community event business license, and associated license conditions for Classical Tahoe an outdoor concert event to be held at the Sierra Nevada College in Incline Village, Nevada on July 14, 15, 19, 20, 21, 22, 23, 24, 26, 27, 28, 29, 30, and August 1, 2, 3, 4, 5, and 6, 2022. The proposed outdoor concerts will be held between the hours of 5:00 p.m. and 9:30 p.m. Primary participant and spectator parking will be within the College campus (APN: 127-040-10). Event organizers estimate that there will be approximately 500 participants and spectators on any one day of the event.

Applicant: Stephanie McCoy
 Property Owner: Sierra Nevada College
 Location: 948 Incline Way Incline Village
 APN: 127-040-10
 Parcel Size: 17.049 Acres
 Master Plan: Commercial (C)
 Regulatory Zone: Public and Semi-Public Facilities (PSP)
 Area Plan: Tahoe
 Development Code: Authorized in Article 808, Administrative Permits; Article 310, Temporary Uses and Structures; and Washoe County Code Chapter 25, Business Licenses, Permits and Regulations
 Commission District: 1 – Commissioner Hill

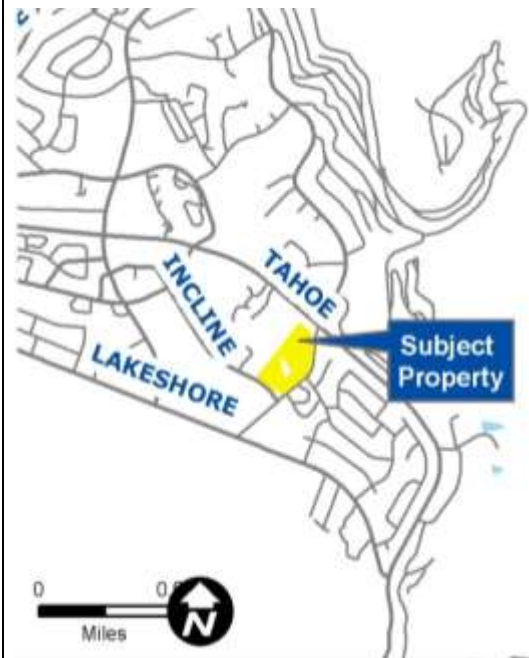

Vicinity Map

STAFF RECOMMENDATION

APPROVE

APPROVE WITH CONDITIONS

DENY

POSSIBLE MOTION

I move that, after giving reasoned consideration to the information contained in the staff report and information received during the public hearing, the Board of Adjustment approve Administrative Permit Case Number WADMIN22-0010 for Stephanie McCoy, with the conditions included as Exhibit A to this matter, having made all five findings in accordance with Washoe County Development Code Section 110.808.25:

(Motion with Findings on Page 8)

Staff Report Contents

Administrative Permit Definition 3

Site Plan.....4

Project Evaluation5

Tahoe Area Plan6

Reviewing Agencies.....7

Staff Comment on Required Findings7

Recommendation8

Motion8

Appeal Process.....9

Exhibits Contents

Conditions of Approval..... Exhibit A

Agency Comments..... Exhibit B

Public NoticeExhibit C

Project ApplicationExhibit D

Administrative Permit Definition

The purpose of an administrative permit is to provide a method of review for a proposed use which possess characteristics that requires a thorough appraisal in order to determine if the use has the potential to adversely affect other land uses, transportation or facilities in the vicinity. The Board of Adjustment or the Hearing Examiner may require conditions of approval necessary to eliminate, mitigate, or minimize to an acceptable level any potentially adverse effects of a use, or to specify the terms under which commencement and operation of the use must comply. Prior to approving an application for an administrative permit, the Board of Adjustment must find that all of the required findings, if applicable, are true.

The conditions of approval for Administrative Permit Case Number WADMIN22-0010 is attached to this staff report and will be included with the action order.

The subject property is designated as Public and Semi-Public Facilities (PSP). The proposed activity, an outdoor community event, is permitted in all regulatory zones subject to approval of an administrative permit in accordance with WCC Section 110.808.00 thru 110.808.65 and Section 110.310.20. Therefore, the applicant is seeking approval of this administrative permit from the Board of Adjustment.

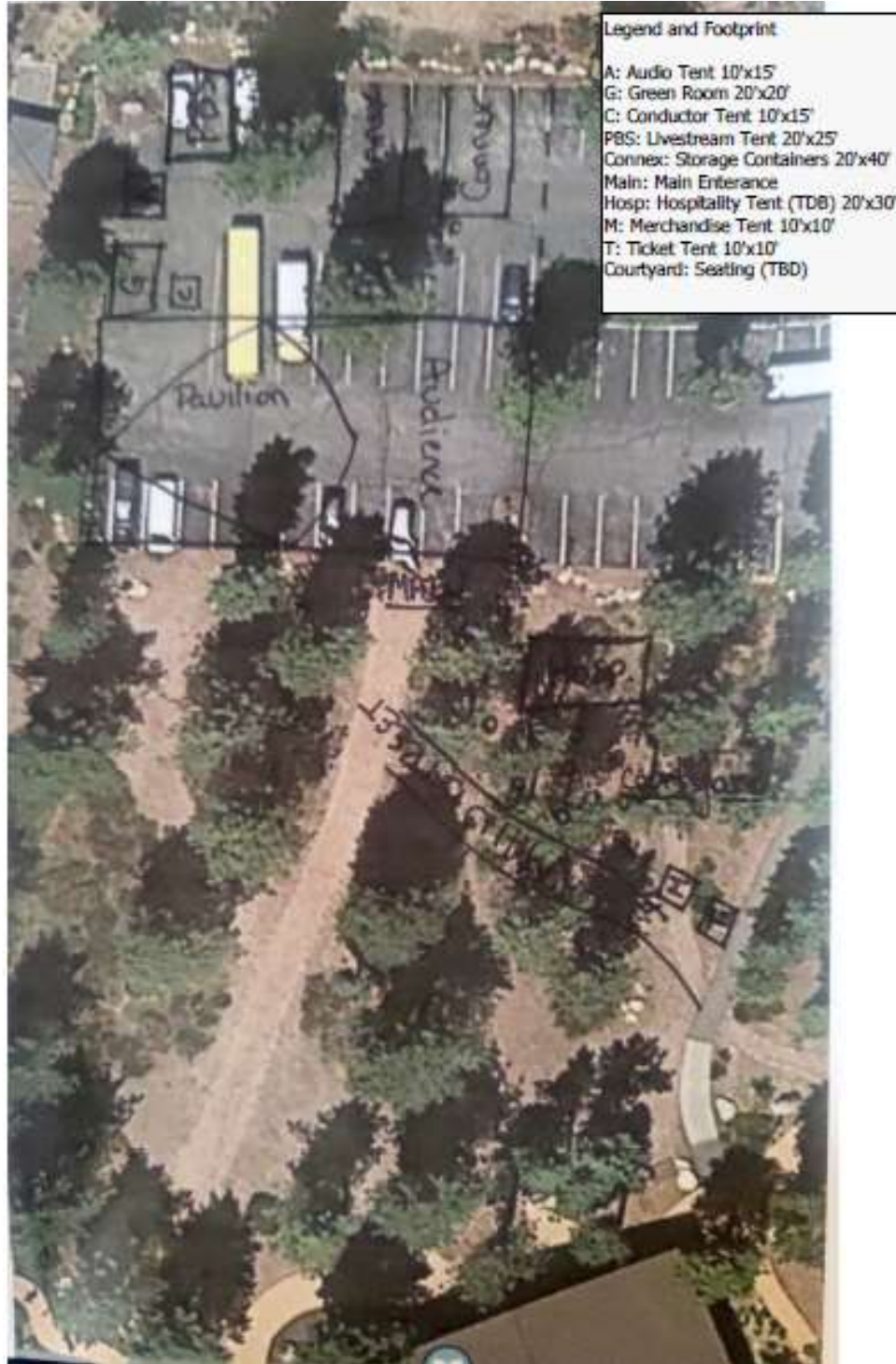

Site Plan

Project Evaluation

Classical Tahoe is a series of outdoor concert events held over a period of 3 weeks. For the 2022 event calendar, Classical Tahoe is scheduled to begin on July 14, 2022, and end on August 6, 2022. Concerts are proposed to be held on the following dates: July 14, 15, 19, 20, 21, 22, 23, 24, 26, 27, 28, 29, 30, and August 1, 2, 3, 4, 5, and 6, 2022. The outdoor concerts are held under a canopy structure erected on the Sierra Nevada College property located in Incline Village. The canopy is proposed to be set up at one of the parking lots near the Primm Library and Patterson Hall, a separate submittal for building permit review will be required for the placement of the canopy structure. Washoe County has been licensing this event since 2012 and issuing administrative permits since 2016. In 2020, no events were held due to the COVID-19 pandemic. Primary participant and spectator parking will be within the College campus. There are three parking lots on the Sierra Nevada Campus which provide 238 parking spaces.

Classical Tahoe intends to follow all CDC, State of Nevada, and Washoe County health guidelines for the 2022 festival. As part of the COVID-19 compliance, the organizers in 2021 adjusted their layout to have all patrons outside the main pavilion structure, and instead only have the musicians under the shell of the pavilion. This layout will continue for the 2022 event cycle. The applicant states that this plan will allow for maximum open-air flow and ample social distancing. The organizers are also planning to have a minimum of 3 feet of space between each pair of seats.

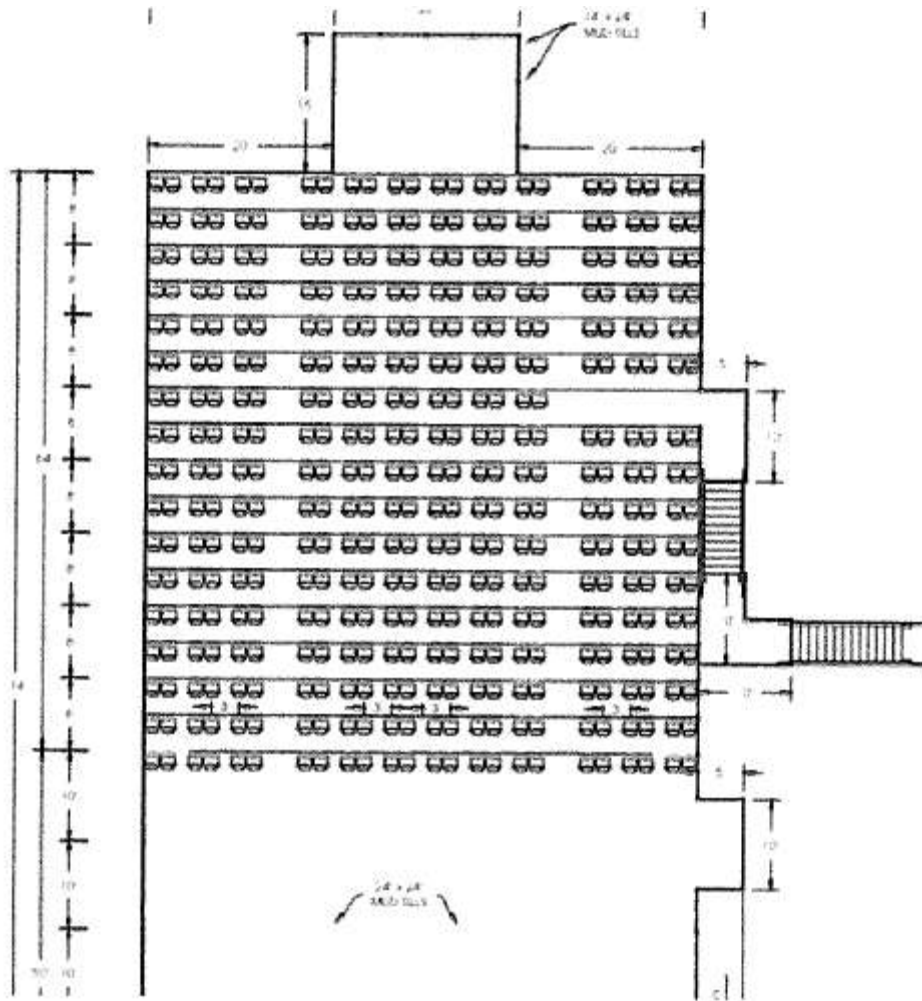

2022 Layout with 3 Feet Spacing

All proposed concerts will be unamplified classical music located within a canopy structure erected on the College campus for the event. The only amplified sound will be that of the announcer. Daytime rehearsals are proposed to run from 10:30 am to 1:30 pm, with the evening concerts taking place between 7 pm and 9:30 pm. Event organizers are planning for a maximum of 480 participants and spectators on any one day of the event, with 400 being patrons and 80 musicians.



Tahoe Area Plan

The subject parcel is located within the Tahoe Area Plan. No pertinent area plan policies were found.

Reviewing Agencies

The following agencies/individuals received a copy of the project application for review and evaluation.

Agencies	Sent to Review	Responded	Provided Conditions	Contact
Washoe County Building & Safety	X	X	X	Dan Holly, dholly@washoecounty.gov
Washoe County Engineering & Capital Projects	X			
Washoe County Land Development	X	X	X	Rob Wimer, rwimer@washoecounty.gov
Washoe County Parks & Open Space	X	X		
Washoe County Planning & Building Director	X			
Washoe County Risk Management	X			
Washoe County Water Rights Manager	X	X	X	Vahid Behmaram, vbehmaram@washoecounty.gov; Timber
WCSO Law Enforcement	X			
WCHD EMS	X	X		
WCHD Environmental Health	X	X	X	Jim English, jenglish@washoecounty.gov;
Regional Transportation Commission (All Apps)	X			
Washoe-Storey Conservation District (All Apps)	X	X	X	Schaffer, shafferjam51@gmail.com;
Incline Village Roads	X	X		
IVGID	X	X		
IVGID - Parks	X			
North Lake Tahoe FPD	X	X	X	Jennifer Donohue, jdonohue@nltpd.net;
Tahoe Regional Planning Agency	X			
Tahoe Transportation District	X			

All conditions required by the contacted agencies can be found in Exhibit A, Conditions of Approval.

Staff Comment on Required Findings

WCC 110.808.25 requires that all of the following findings be made to the satisfaction of the Washoe County Board of Adjustment before granting approval of the administrative permit request. Staff has completed an analysis of the application and has determined that the proposal is in compliance with the required findings as follows.

- (a) **Consistency.** That the proposed use is consistent with the action programs, policies, standards and maps of the Master Plan and the Tahoe Area Plan.

Staff Comment: The proposed outdoor community event, a series of outdoor concerts and supplemental movie nights to be conducted on the grounds of the Sierra Nevada College, is a permitted use with the approval of an administrative permit. There are no programs, policies, maps, or standards in any of the relevant Washoe County Plans that are inconsistent with this use

- (b) **Improvements.** That adequate utilities, roadway improvements, sanitation, water supply, drainage, and other necessary facilities have been provided, the proposed improvements are properly related to existing and proposed roadways, and an adequate public facilities determination has been made in accordance with Division Seven.

Staff Comment: Electric, water utilities, and sanitation are provided by public utilities and agencies and are adequate; roadways are capable of serving the event. Staff is confident that the necessary facilities are in place or will be in place as the result of a condition for the duration of the event.

- (c) Site Suitability. That the site is physically suitable for an outdoor community event and for the intensity of such a development.

Staff Comment: The proposed site is particularly suitable for this event. The lawn areas of Sierra Nevada College are capable of hosting the expected crowds and there is adequate room for the set-up of the necessary facilities and equipment. The successful use of this area last year, and the preceding years is an indication that the site is suitable for this event.

- (d) Issuance Not Detrimental. That issuance of the permit will not be significantly detrimental to the public health, safety or welfare; injurious to the property or improvements of adjacent properties; or detrimental to the character of the surrounding area.

Staff Comment: The administrative permit review process ensures that all appropriate agencies have recommended the necessary conditions necessary for mitigation of any negative impact to the public health, safety, and welfare of the area, surrounding properties will not be unduly injured nor will the character of the surrounding area be harmed. The conditions of approval impose noise controls (minimal amplification) and hours of operation to assure minimum impact on surrounding properties, and no surrounding property owners have responded to the notice sent to them objecting to the event.

- (e) Effect on a Military Installation. Issuance of the permit will not have a detrimental effect on the location, purpose or mission of the military installation.

Staff Comment: There is no military installation within the required noticing distance for this application; therefore, this finding is not required to be made.

Recommendation

After a thorough analysis and review, Administrative Permit Case Number WADMIN22-0010 is being recommended for approval with conditions.

Motion

I move that, after giving reasoned consideration to the information contained in the staff report and information received during the public hearing, the Board of Adjustment approve Administrative Permit Case Number WADMIN22-0010 for Stephanie McCoy, with the conditions included as Exhibit A to this matter, having made all five findings in accordance with Washoe County Development Code Section 110.808.25:

- (a) Consistency. That the proposed use is consistent with the action programs, policies, standards and maps of the Master Plan and the Tahoe Area Plan;
- (b) Improvements. That adequate utilities, roadway improvements, sanitation, water supply, drainage, and other necessary facilities have been provided, the proposed improvements are properly related to existing and proposed roadways, and an adequate public facilities determination has been made in accordance with Division Seven;
- (c) Site Suitability. That the site is physically suitable for an outdoor community event and for the intensity of such a development.

- (d) Issuance Not Detrimental. That issuance of the permit will not be significantly detrimental to the public health, safety or welfare; injurious to the property or improvements of adjacent properties; or detrimental to the character of the surrounding area;
- (e) Effect on a Military Installation. Issuance of the permit will not have a detrimental effect on the location, purpose or mission of the military installation.

Appeal Process

Board of Adjustment action will be effective 10 calendar days after the written decision is filed with the Secretary to the Board of Adjustment and mailed to the original applicant, unless the action is appealed to the Washoe County Board of County Commissioners, in which case the outcome of the appeal shall be determined by the Washoe County Board of County Commissioners. Any appeal must be filed in writing with the Planning and Building Division within 10 calendar days from the date the written decision is filed with the Secretary to the Board of Adjustment and mailed to the original applicant.

Applicant: Stephanie McCoy
stephanie@classicaltahoe.org

Property Owner: Sierra Nevada University Campus
999 Tahoe Blvd, Incline Village, NV 89451



Conditions of Approval

Administrative Permit Case Number WADMIN22-0010

The project approved under Administrative Permit Case Number WADMIN22-0010 shall be carried out in accordance with the conditions of approval granted by the Board of Adjustment on June 2, 2022. Conditions of approval are requirements placed on a permit or development by each reviewing agency. These conditions of approval may require submittal of documents, applications, fees, inspections, amendments to plans, and more. These conditions do not relieve the applicant of the obligation to obtain any other approvals and licenses from relevant authorities required under any other act or to abide by all other generally applicable codes, and neither these conditions nor the approval by the County of this project/use override or negate any other applicable restrictions on uses or development on the property.

Unless otherwise specified, all conditions related to the approval of this administrative permit shall be met or financial assurance must be provided to satisfy the conditions of approval prior to issuance of a grading or building permit. The agency responsible for determining compliance with a specific condition shall determine whether the condition must be fully completed or whether the applicant shall be offered the option of providing financial assurance. All agreements, easements, or other documentation required by these conditions shall have a copy filed with the County Engineer and the Planning and Building Division.

Compliance with the conditions of approval related to this administrative permit is the responsibility of the applicant, his/her successor in interest, and all owners, assignees, and occupants of the property and their successors in interest. Failure to comply with any of the conditions imposed in the approval of the administrative permit may result in the initiation of revocation procedures.

Operational conditions are subject to review by the Planning and Building Division prior to the renewal of a business license each year. Failure to adhere to the operational conditions may result in the Planning and Building Division recommending that the business license not be renewed until conditions are complied with to the satisfaction of Washoe County.

Washoe County reserves the right to review and revise the conditions of approval related to this Administrative Permit should it be determined that a subsequent license or permit issued by Washoe County violates the intent of this approval.

For the purpose of conditions imposed by Washoe County, “may” is permissive and “shall” or “must” is mandatory.

Conditions of approval are usually complied with at different stages of the proposed project. Those stages are typically:

- Prior to permit issuance (i.e., grading permits, building permits, etc.).
- Prior to obtaining a final inspection and/or a certificate of occupancy.
- Prior to the issuance of a business license or other permits/licenses.
- Some “conditions of approval” are referred to as “operational conditions.” These conditions must be continually complied with for the life of the project or business.

The Washoe County Commission oversees many of the reviewing agencies/departments with the exception of the following agencies:

- **The REGIONAL TRANSPORTATION COMMISSION (RTC) is directed and governed by its own Board. Conditions recommended by the RTC may be required, at the discretion of Washoe County.**

FOLLOWING ARE CONDITIONS OF APPROVAL REQUIRED BY THE REVIEWING AGENCIES. EACH CONDITION MUST BE MET TO THE SATISFACTION OF THE ISSUING AGENCY.

Washoe County Planning and Building Division

1. The following conditions are requirements of the Planning and Building Division, which shall be responsible for determining compliance with these conditions.

**Contact Name – Chris Bronczyk, Senior Planner, 775.328.3612,
cbronczyk@washoecounty.gov**

- a. **The applicant shall attach a copy of the action order approving this project to all permits and applications (including building permits) applied for as part of this administrative permit.**
- b. The applicant shall demonstrate substantial conformance to the plans approved as part of this administrative permit. Planning and Building shall determine compliance with this condition.
- c. The applicant shall submit construction plans, with all information necessary for comprehensive review by Washoe County, and initial building permits shall be issued within two years from the date of approval by Washoe County. The applicant shall complete construction within the time specified by the building permits. Compliance with this condition shall be determined by the Planning and Building Division.
- d. An Outdoor Community Event business license for Classical Tahoe shall be issued after all pre-event conditions are met and prior to commencing of concerts.

DURING-EVENT CONDITIONS:

- e. Hours of Operation: All concerts shall end by 9:30 p.m. and all activities shall end by 10:30 p.m.
- f. Noise: The music shall not be amplified during any concert. Amplified sound for the announcer at the concerts and for the supplemental movie nights shall not be audible past the property boundary.
- g. Restroom Facilities: Must be open and available to the concert participants at least 30 minutes before and after the concert, and during the entire time that food or beverages are sold.
- h. Lighting: All outdoor lighting, other than standard campus lighting, shall be turned off by 10:30 p.m.

POST-EVENT CONDITIONS:

- i. Clean up: The applicant shall be responsible for total clean-up of the site. The tent structure shall be removed within 48 hours of the final concert.

Washoe County Health District

2. The following condition is a requirement of the Health District, which shall be responsible for determining compliance with this condition. The District Board of Health has jurisdiction over all public health matters in the Health District. Any conditions set by the Health District must be appealed to the District Board of Health.

Contact Name – James English, EHS Supervisor, jenglish@washoecounty.gov

- a. WCHD has reviewed the referenced application and note the event is the annual Classical Tahoe outdoor concert series.
- b. WCHD notes the Sierra Nevada College Campus is now owned and managed by the Nevada System of Higher Education. Therefore WCHD has no jurisdiction on this event. Please contact the State of Nevada Bureau of Public Health for any permitting or event requirements.
- c. WCHD recommends garbage service and access to bathrooms remain the same as in previous years.

North Lake Tahoe Fire Protection District

3. The following conditions are requirements of North Lake Tahoe Fire Protection District, which shall be responsible for determining compliance with these conditions.

Contact Name – Jennifer Donohue; jdonohue@nltpd.net

- a. A separate permit is required for special event/temporary membrane structure. Application shall be submitted thirty (30) days in advance and may be submitted electronically to plans@nltpd.net.
- b. Where required or when requested, ambulance standby requests shall be submitted sixty (60) days in advance to ensure staffing.
- c. When/where applicable, a separate building permit is required for platforms, stages, or other temporary structures (telescoping seating).

Washoe County Building Division

4. The following conditions are requirements of the Building Division, which shall be responsible for determining compliance with these conditions.

Contact Name – Rosa Landis, 775.328.2034, rlandis@washoecounty.gov

- a. Any tents or temporary structures associated with this event must comply with the 2018 International Building Code and Washoe County Chapter 100

*** End of Conditions ***

From: [Landis, Rosa](#)
To: [Bronczyk, Christopher](#)
Subject: April Agency Review - Memorandum II, Items 4 & 6
Date: Monday, April 25, 2022 2:20:00 PM
Attachments: [image001.png](#)
[image002.png](#)
[image003.png](#)
[image004.png](#)
[image005.png](#)

Good afternoon Chris,

I have reviewed items 4 & 6 for the Building Division and here are my comments:

Item 4

- Any tents or temporary structures associated with this event must comply with the 2018 International Building Code and Washoe County Chapter 100

Item 6

- The proposed sewer lift station will need to comply with the 2018 International Building Code. A sewer lift station is considered a Group U occupancy classification.

Please let me know if you have any questions or need any additional information.

Thank you,



Rosa Landis

ICC Certified Plans Examiner | Community Services Department

RLandis@washoecounty.gov | Direct Line: 775.328.2034

In-Office Hours: Mon & Tues, 7:30 am – 4:30pm

Visit us online: www.washoecounty.us/csd

For Building call: 775.328.2020

Building Email: building@washoecounty.gov

1001 E. 9th Street, Reno, NV 89512



Have some kudos to share about a Community Services Department employee or experience?

☆ [Submit a Nomination](#) ☆

**** Please notify the Permit Technician you have been working with or building@washoecounty.us when you have uploaded corrections, revisions, or ANY new document. ****

From: [Program, EMS](#)
To: [Bronczyk, Christopher](#)
Cc: [Program, EMS](#); [Jennifer Donohue](#)
Subject: FW: April Agency Review Memo II
Date: Thursday, April 21, 2022 7:53:51 AM
Attachments: [Outlook-5ktczocx.png](#)
[Outlook-shwvdoda.png](#)
[Outlook-ol5jizyw.png](#)
[Outlook-nmei4suz.png](#)
[Outlook-ohkmubn1.png](#)
[April Agency Review Memo II.pdf](#)

Good morning,

In reviewing the application for the Classical Tahoe event, the event does not meet the requirements to have EMS coverage at the event.

Please be aware that the setup for this event will overlap the teardown of the fashion show in the same area on August 6th from 11AM – 2PM.

NLTFPD Fire Marshal Jennifer Donohue has been CC'd for visibility.

Thank you,

Sabrina.

Sabrina Brasuell

EMS Coordinator | Epidemiology and Public Health Preparedness
Washoe County Health District
sbrasuell@washoecounty.gov | Cell: (775) 830-7118 | Office: (775) 326-6043
1001 E. Ninth St., Bldg. B. Reno, NV 89512

From: Albarran, Adriana <AAlbarran@washoecounty.gov>
Sent: Friday, April 15, 2022 3:42 PM
To: Rosa, Genine <GRosa@washoecounty.gov>; Restori, Joshua <JRestori@washoecounty.gov>; Program, EMS <EMSProgram@washoecounty.gov>; Rubio, Wesley S <WRubio@washoecounty.gov>; English, James <JEnglish@washoecounty.gov>; Kelly, David A <DAKelly@washoecounty.gov>
Cc: EHS Plan Review <EHSPlanReview@washoecounty.gov>
Subject: April Agency Review Memo II

Good afternoon,

Please find the attached [Agency Review Memo II](#) with cases received in April by the

Washoe County Community Services Department, Planning and Building Division.

You've been asked to review the following applications:

- Genine / Joshua - Item 2, 6-7
- Jim / Wes / David - All Items
- EMS - Item 1-5, 7-8
-

The item descriptions and links to the applications are provided in the memo. *Comments are due by **April 26, 2022 for BOA** and **May 3, 2022 for PMRC**.*

Please remember to send any agency review responses/comments directly to the Planner for the case, rather than replying to me.

Regards,

Adriana Albarran

Office Support Specialist, Planning & Building Division | Community Services Department

aalbarran@washoecounty.gov | Direct Line: 775.328.2721

My working hours: Monday-Friday 8:00am to 4:30pm

Visit us first online: www.washoecounty.gov/csd

Planning Division: 775.328.6100 | Planning@washoecounty.gov

CSD Office Hours: Monday-Friday 8:00am to 4:00pm

1001 East Ninth Street, Reno, NV 89512



Have some kudos to share about a Community Services Department employee or experience?

[Submit a Nomination](#)





WASHOE COUNTY

COMMUNITY SERVICES DEPARTMENT

Engineering and Capital Projects

1001 EAST 9TH STREET
RENO, NEVADA 89512
PHONE (775) 328-3600
FAX (775) 328.3699

INTEROFFICE MEMORANDUM

DATE: April 26, 2022

TO: Chris Bronczyk, Planner, Planning and Building Division

FROM: Robert Wimer, P.E., Engineering and Capital Projects Division

SUBJECT: **WADMIN22-0010**
APN 127-040-10
Classical Tahoe

GENERAL PROJECT DISCUSSION

Washoe County Engineering staff has reviewed the above referenced application. The Engineering and Capital Projects Division recommends approval with no conditions.



**WASHOE COUNTY
HEALTH DISTRICT**
ENHANCING QUALITY OF LIFE

April 27, 2022

Washoe County Community Services
Planning and Development Division

RE: Classical Tahoe; APN 127-040-10
Administrative Permit; WADMIN22-0010

Dear Washoe County Staff:

The following conditions are requirements of the Washoe County Health District, Environmental Health Services Division (WCHD), which shall be responsible for determining compliance with these conditions.

Contact Name – James English - jenglish@washoecounty.us

- a) Condition #1: WCHD has reviewed the referenced application and note the event is the annual Classical Tahoe outdoor concert series.
- b) Condition #2: WCHD notes the Sierra Nevada College Campus is now owned and managed by the Nevada System of Higher Education. Therefore WCHD has no jurisdiction on this event. Please contact the State of Nevada Bureau of Public Health for any permitting or event requirements.
- c) Condition #3: WCHD recommends garbage service and access to bathrooms remain the same as in previous years.

If you have any questions or would like clarification regarding the foregoing, please contact James English, EHS Supervisor at jenglish@washoecounty.us regarding all Health District comments.

Sincerely,

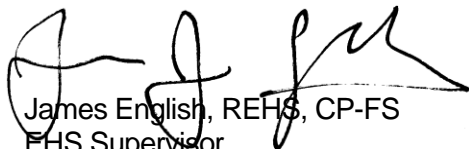

James English, REHS, CP-FS
EHS Supervisor
Environmental Health Services
Washoe County Health District

Date	4-15-22
Attention	Chris Bronczyk
Re	WADMIN22-0010
APN	127-040-10
Service Address	948 Incline Way
Owner	Sierra Nevada College

Administrative Permit Case Number WADMIN22-0010 (Classical Tahoe) - For hearing, discussion, and possible action to approve an administrative permit and outdoor community event business license, and associated license conditions for Classical Tahoe an outdoor concert event to be held at the Sierra Nevada College in Incline Village, Nevada on July 14, 15, 19, 20, 21, 22, 23, 24, 26, 27, 28, 29, 30, and August 1, 2, 3, 4, 5, and 6, 2022. The proposed outdoor concerts will be held between the hours of 5:00 p.m. and 9:30 p.m. Primary participant and spectator parking will be within the College campus (APN: 127-040-10). Event organizers estimate that there will be approximately 500 participants and spectators on any one day of the event.

- Applicant: Stephanie McCoy
- Property Owner: Sierra Nevada College
- Location: 948 Incline Way Incline Village, NV 89451
- APN: 127-040-10
- Parcel Size: 17.049 Acres
- Master Plan: Commercial (C)
- Regulatory Zone: Public and Semi-Public Facilities (PSP)
- Area Plan: Tahoe
- Development Code: Authorized in Article 808, Administrative Permits; Article 310, Temporary Uses and Structures; and Washoe County Code Chapter 25, Business Licenses, Permits and Regulations
- Commission District: 1 – Commissioner Hill
- Staff: Chris Bronczyk, Senior Planner
Washoe County Community Services Department
Planning and Building Division
- Phone: 775-328-3612
- E-mail: cbronczyk@washoecounty.gov

IVGID Comments: No Impact to the Incline Village General Improvement District.

From: [Jennifer Donohue](#)
To: [Bronczyk, Christopher](#)
Cc: stephanie@classicaltahoe.org; [Jeffrey Smith](#)
Subject: NLTFPD Review of WADMIN22-0010
Date: Tuesday, April 19, 2022 12:15:14 PM

[**NOTICE:** This message originated outside of Washoe County -- **DO NOT CLICK** on **links** or open **attachments** unless you are sure the content is safe.]

Greetings,

The following are NLTFPD's comments/conditions for WADMIN22-0010:

1. A separate permit is required for special event/temporary membrane structure. Application shall be submitted thirty (30) days in advance and may be submitted electronically to plans@nltpd.net.
2. Where required or when requested, ambulance standby requests shall be submitted sixty (60) days in advance to ensure staffing.
3. When/where applicable, a separate building permit is required for platforms, stages, or other temporary structures (telescoping seating).

Regards,



Jennifer Donohue
Fire Marshal

Office: [775.831.0351](tel:775.831.0351) x8127 | Cell: [775.434.4555](tel:775.434.4555)
Email: jdonohue@nltpd.net
[866 Oriole Way | Incline Village | NV 89451](#)



From: [Kirschenman, Sophia](#)
To: [Bronczyk, Christopher](#)
Subject: Parks Comments Re: WADMIN22-0010
Date: Thursday, April 28, 2022 5:14:37 PM
Attachments: [Outlook-wxujwyg.png](#)
[Outlook-0v2q4kse.png](#)
[Outlook-xhrlpjvo.png](#)
[Outlook-ffcdjbdk.png](#)
[Outlook-orsl4oq.png](#)

Hi Chris,

I've reviewed WADMIN22-0010 (Classical Tahoe) on behalf of Washoe County Regional Parks and Open Space and have no comments or conditions.

Thank you,



[Sophia Kirschenman](#)
Park Planner | Community Services Department
775.328.3623 | 1001 E. 9th Street, Reno, NV 89512

[My working hours: Monday-Friday 8 am to 5 pm](#)

Please consider the environment before printing this e-mail.

From: [Thomsen, Richard](#)
To: [Bronczyk, Christopher](#)
Cc: [Albarran, Adriana](#)
Subject: Re: April Agency Review Memo II
Date: Monday, April 18, 2022 11:09:44 AM
Attachments: [Outlook-ka0f240y.png](#)
[Outlook-54h4o5k5.png](#)
[Outlook-btdqappn.png](#)
[Outlook-ly223ap.png](#)
[Outlook-f3iqviua.png](#)
[Outlook-r0j1y5fo.png](#)
[Outlook-3eh1fwa0.png](#)
[Outlook-0cjc3qcm.png](#)
[Outlook-cid1wlur.png](#)
[Outlook-rap5k3sn.png](#)

Chris,

I have reviewed the application for item 4, Administrative Permit Case Number WADMIN22-0010 (Classical Tahoe) I have no objections or conditions for this event.

Thank you,



Rich Thomsen
Road Operations Supervisor | CSD Incline Village
RThomsen@washoecounty.gov | Office: 775.328.2180
625 Mt. Rose Highway Incline Village NV 89451



From: Albarran, Adriana <AAlbarran@washoecounty.gov>
Sent: Friday, April 15, 2022 3:45 PM
To: Thomsen, Richard <RThomsen@washoecounty.gov>
Subject: April Agency Review Memo II

Good afternoon,

Please find the attached [Agency Review Memo II](#) with cases received in April by the Washoe County Community Services Department, Planning and Building Division.

You've been asked to review the following applications:

- WADMIN22-0010 Classical Tahoe - Item 4

The item descriptions and links to the applications are provided in the memo. Comments are due by April 26.

Please remember to send any agency review responses/comments directly to the Planner for the case, rather than replying to me.

Regards,



Adriana Albarran

Office Support Specialist, Planning & Building Division | Community Services Department

aalbarran@washoecounty.gov | Direct Line: 775.328.2721

My working hours: Monday-Friday 8:00am to 4:30pm

Visit us first online: www.washoecounty.gov/csd

Planning Division: 775.328.6100 | Planning@washoecounty.gov

CSD Office Hours: Monday-Friday 8:00am to 4:00pm

1001 East Ninth Street, Reno, NV 89512



Have some kudos to share about a Community Services Department employee or experience?

[Submit a Nomination](#)



WASHOE COUNTY
COMMUNITY SERVICES
INTEGRITY COMMUNICATION SERVICE

1001 E. 9th Street
Reno, NV 89512
Phone: (775) 328-3600
Fax: (775) 328-3699

April 27, 2022

TO: Chris Bronczyk, Senior Planner, CSD, Planning & Development Division
FROM: Timber Weiss, Licensed Engineer, CSD
SUBJECT: Administrative Permit Case Number WADMIN22-0010 (Classical Tahoe)

Project description:

For hearing, discussion and possible action to approve an administrative permit and outdoor community event business license, and associated license conditions for Classical Tahoe an outdoor concert event to be held at the Sierra Nevada College in Incline Village, Nevada on July 14, 15, 19, 20, 21, 22, 23, 24, 26, 27, 28, 29, 30, and August 1, 2, 3, 4, 5, and 6, 2022. The proposed outdoor concerts will be held between the hours of 5:00 p.m. and 9:30 p.m. Primary participant and spectator parking will be within the College campus (APN: 127-040-10). Event organizers estimate that there will be approximately 500 participants and spectators on any one day of the event.

Location: 948 Incline Way. Assessor's Parcel Number:
127-040-10.

The Community Services Department (CSD) recommends approval of this project with the following Water Rights comments and/or conditions:

Comments:

This parcel is within IVGID service area and currently receives municipal water service from IVGID. The applicant shall conform with the requirements of IVGID in regards to water rights and water service.

Conditions:

There are no conditions of approval for this permit.



Washoe-Storey Conservation District

Bret Tyler Chairmen
Jim Shaffer Treasurer
Cathy Canfield Storey app
Jean Herman Washoe app

1365 Corporate Blvd.
Reno NV 89502
775 857-8500 ext. 131
nevadaconservation.com

April 25, 2022

Washoe County Community Services Department

C/O Chris Bronczyk, Senior Planner

1001 E Ninth Street, Bldg. A

Reno, NV 89512

R: WADMIN22-0010 Classical Tahoe

Dear Chris,

In reviewing the permit for an Outdoor Community Event and business license, the Conservation District has no comments.

Thank you for providing us the opportunity to review the project that may have impacts on our natural resources and if there are any questions call us at (775) 750-8272.

Sincerely,

Jim Shaffer



367 Parcels within 750 Feet

**OUTDOOR
COMMUNITY EVENT
LICENSE APPLICATION**

**1001 EAST 9TH STREET, BUILDING A
RENO, NEVADA 89512**

**(775) 328-3733
www.washoecounty.us**

OUTDOOR COMMUNITY EVENT APPLICATION

(Requires a non-refundable \$50 application fee)

Application date: 4/1/2022

Applicant Information

Applicant's name: Stephanie McCoy

Mailing address: 1676 Round Mountain Circle Sparks NV 89434
Street or PO Box City State Zip code

Phone: 775-298-0245 (Business) [REDACTED] (Home) _____ (Cell)

Email: Stephanie@ClassicalTahoe.org

All applicants, to include corporate officers or partners must complete a personal history form

Is the applicant a(n): Corporation Partnership Individual

If a corporation or a partnership, list corporate officers or partners:

Name	Address	Title

Event Information

Name of Event: Classical Tahoe 2022

Date(s) of Event: See Attachment A Hours of operation: 5pm-9:30pm

Location of Event: Sierra Nevada University Campus / UNR Campus

Assessor Parcel Number(s): 12704010

Description of Event: Dates are: 7/14, 7/15, 7/19, 7/20, 7/21, 7/22, 7/23, 7/24, 7/26, 7/27, 7/28, 7/29, 7/30, 8/1, 8/2, 8/3, 8/4, 8/5, 8/6

Name of the designated event representative who will be on-site during the event and who has authority to bind the applicant: Stephanie McCoy, Karen Craig

Will an admission fee be charged for your event? Yes No

If yes, amount and type of fee(s): \$35-\$155 (tickets for concerts only)

When will fee be collected? Pre-sales At entrance

Approximate number of participants and other persons: 300-500 max

Approximate number of customers and spectators: Approx 1300/weekend

Approximate maximum number of persons on any one day of the event: 450-500 Max

Will food and/or beverages be served? Yes No

(all food and beverage vendors must have the appropriate Washoe County Health District permits)

Will alcoholic beverages be served? Yes No

(all intoxicating liquor vendors must be individually licensed with Washoe County Business License)

Will there be live music? Yes No

OUTDOOR COMMUNITY EVENT LICENSE

Insurer Information

(see Insurance, Hold Harmless & Indemnification Requirements)

Name of Insurer: Menah Insurance Policy number: PAC308530202

Attach copy of insurance policy specific to event (must be furnished prior to the issuance of the license)

Address of Insurer: 333 Village Blvd Incline Village NV 89451
Street City State Zip code

Limits of liability: \$1 million

HISTORY OF SIMILAR EVENTS

(attach additional sheets if needed)

Describe the history of all similar events conducted, operated or promoted by the applicant. Include, at a minimum, event names, types, dates, locations, permits or licenses issued.

please see Attachment A for full details. Required permits were acquired for all past festivals (2012-2021) from Washoe County, fire Dept, and TRPA.

Vendor List

(attach additional sheets if needed)

Name of Vendor

Type of service or product

None



CERTIFICATE OF LIABILITY INSURANCE

DATE (MM/DD/YYYY)
04/16/2021

THIS CERTIFICATE IS ISSUED AS A MATTER OF INFORMATION ONLY AND CONFERS NO RIGHTS UPON THE CERTIFICATE HOLDER. THIS CERTIFICATE DOES NOT AFFIRMATIVELY OR NEGATIVELY AMEND, EXTEND OR ALTER THE COVERAGE AFFORDED BY THE POLICIES BELOW. THIS CERTIFICATE OF INSURANCE DOES NOT CONSTITUTE A CONTRACT BETWEEN THE ISSUING INSURER(S), AUTHORIZED REPRESENTATIVE OR PRODUCER, AND THE CERTIFICATE HOLDER.

IMPORTANT: If the certificate holder is an ADDITIONAL INSURED, the policy(ies) must have ADDITIONAL INSURED provisions or be endorsed. If SUBROGATION IS WAIVED, subject to the terms and conditions of the policy, certain policies may require an endorsement. A statement on this certificate does not confer rights to the certificate holder in lieu of such endorsement(s).

PRODUCER Menath Insurance 1325 Airmotive Way Suite 320 Reno NV 89502	CONTACT NAME: Traci Koon PHONE (A/C, No, Ext): (775) 831-3132 E-MAIL ADDRESS: tkoon@menath.com	FAX (A/C, No): (775) 831-6235
	INSURER(S) AFFORDING COVERAGE	
INSURED Classical Tahoe 948 Incline Way Incline Village NV 89450	INSURER A: Great American Insurance Comp	NAIC # 16691
	INSURER B:	
	INSURER C:	
	INSURER D:	
	INSURER E:	
	INSURER F:	

COVERAGES **CERTIFICATE NUMBER:** CL2141646856 **REVISION NUMBER:**

THIS IS TO CERTIFY THAT THE POLICIES OF INSURANCE LISTED BELOW HAVE BEEN ISSUED TO THE INSURED NAMED ABOVE FOR THE POLICY PERIOD INDICATED. NOTWITHSTANDING ANY REQUIREMENT, TERM OR CONDITION OF ANY CONTRACT OR OTHER DOCUMENT WITH RESPECT TO WHICH THIS CERTIFICATE MAY BE ISSUED OR MAY PERTAIN, THE INSURANCE AFFORDED BY THE POLICIES DESCRIBED HEREIN IS SUBJECT TO ALL THE TERMS, EXCLUSIONS AND CONDITIONS OF SUCH POLICIES. LIMITS SHOWN MAY HAVE BEEN REDUCED BY PAID CLAIMS.

INSR LTR	TYPE OF INSURANCE	ADDL INSD	SUBR WVD	POLICY NUMBER	POLICY EFF (MM/DD/YYYY)	POLICY EXP (MM/DD/YYYY)	LIMITS
A	<input checked="" type="checkbox"/> COMMERCIAL GENERAL LIABILITY <input type="checkbox"/> CLAIMS-MADE <input checked="" type="checkbox"/> OCCUR GEN'L AGGREGATE LIMIT APPLIES PER: <input checked="" type="checkbox"/> POLICY <input type="checkbox"/> PRO-JECT <input type="checkbox"/> LOC OTHER:	Y		PAC308530202	04/10/2021	04/10/2022	EACH OCCURRENCE \$ 1,000,000
	DAMAGE TO RENTED PREMISES (Ea occurrence) \$ 100,000						
	<input type="checkbox"/> ANY AUTO <input type="checkbox"/> OWNED AUTOS ONLY <input type="checkbox"/> HIRED AUTOS ONLY <input type="checkbox"/> SCHEDULED AUTOS <input type="checkbox"/> NON-OWNED AUTOS ONLY						COMBINED SINGLE LIMIT (Ea accident) \$ BODILY INJURY (Per person) \$ BODILY INJURY (Per accident) \$ PROPERTY DAMAGE (Per accident) \$ \$
	<input type="checkbox"/> UMBRELLA LIAB <input type="checkbox"/> EXCESS LIAB DED RETENTION \$						<input type="checkbox"/> OCCUR <input type="checkbox"/> CLAIMS-MADE EACH OCCURRENCE \$ AGGREGATE \$ \$
	<input type="checkbox"/> WORKERS COMPENSATION AND EMPLOYERS' LIABILITY ANY PROPRIETOR/PARTNER/EXECUTIVE OFFICER/MEMBER EXCLUDED? (Mandatory in NH) If yes, describe under DESCRIPTION OF OPERATIONS below		N/A				<input type="checkbox"/> PER STATUTE <input type="checkbox"/> OTH-ER E.L. EACH ACCIDENT \$ E.L. DISEASE - EA EMPLOYEE \$ E.L. DISEASE - POLICY LIMIT \$

DESCRIPTION OF OPERATIONS / LOCATIONS / VEHICLES (ACORD 101, Additional Remarks Schedule, may be attached if more space is required)

Certificate holder is included as additional insured as respects the insureds operations on behalf of the certificate holder.

CERTIFICATE HOLDER Sierra Nevada College 999 Tahoe Blvd Incline Village NV 89451	CANCELLATION SHOULD ANY OF THE ABOVE DESCRIBED POLICIES BE CANCELLED BEFORE THE EXPIRATION DATE THEREOF, NOTICE WILL BE DELIVERED IN ACCORDANCE WITH THE POLICY PROVISIONS.
	AUTHORIZED REPRESENTATIVE 

© 1988-2015 ACORD CORPORATION. All rights reserved.

Classical Tahoe is an outdoor orchestra concert series held in Incline Village, NV for three weeks. This year our festival is scheduled to begin on July 14, 2022 and conclude on August 6, 2022. We have previously had events every summer since 2012, during the same span of time (mid July-mid August).

Classical Tahoe is planning to follow all CDC and State of Nevada/Washoe County health guidelines for our 2022 festival, to be engaged, knowledgeable, and responsible partners during the next phase of the pandemic. In 2021 we adjusted our layout to have all patrons outside of our main pavilion structure, and have only the musicians underneath the shell of the pavilion, which will be constructed to be an amphitheater. This plan allows for maximum open-air flow and ample social distance. Please see the following image to show the current layout



An image from our 2021 festival showing the audience outdoors and the musicians under the canopy.

The festival will still be un-amplified this year. We will observe all quiet times for Washoe County. Our daytime rehearsals run from 10:30 am-1:30 pm, and our evening concerts run from 7pm-9:30pm on Fridays and Saturdays. Please see attached schedule for detailed start and end times.

Classical Tahoe plans to employ 80 musicians (65 max in residence during any given week of the festival) for the three week duration. We will be asking all musicians to show proof of vaccination.

We will have a maximum of 400 patrons at each open-air concert. We are planning to have a minimum of 3 feet of space between each pair of seats, and we will be selling seats in family/couple units.

Risers for just 17 rows are engineered to be built open-air in the forest under the stars. Seats will be permanently secured to the risers in pairs of two with 3 feet of space between each pair. We are currently planning to use the restrooms at Sierra Nevada University, and we will ensure they are cleaned and sanitized frequently, especially during concerts and events. If needed, we are prepared to bring on portable restrooms.

Please see the attached safety protocols developed with our Health Advisor, Dr. Helen Trop-Zell, for detailed information regarding the safety measures we will be taking during all rehearsals and performances.

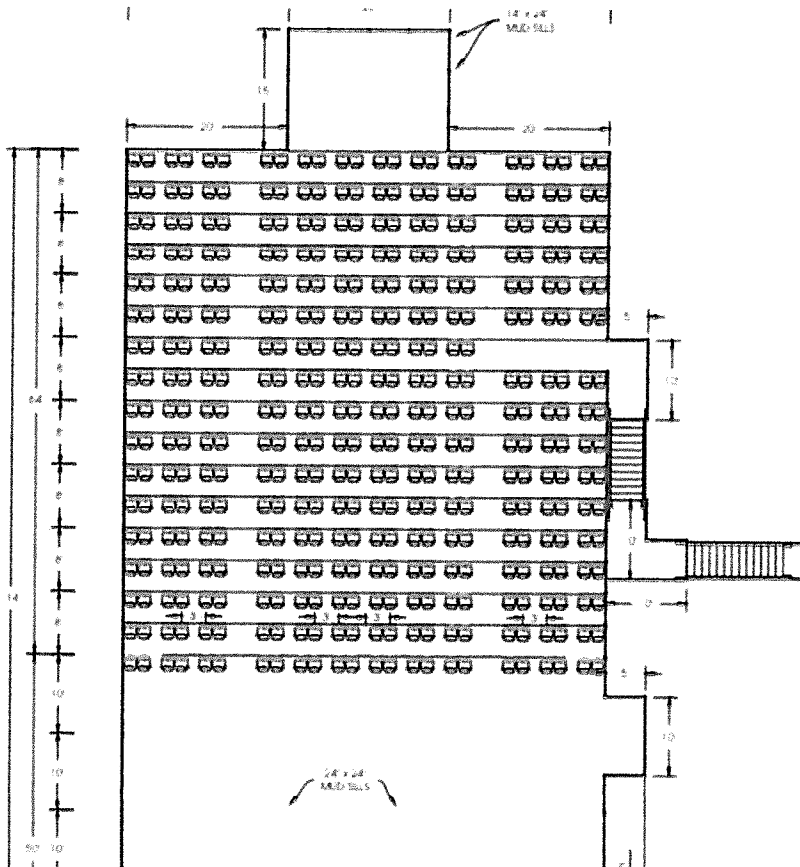

Event Operation Details Classical Tahoe 2022

Security and Fire protection:

Security will be provided by the on-site college security staff of Sierra Nevada University. If it is deemed necessary to provide additional security Classical Tahoe (CT) is prepared to get private security. A temporary electronic security monitoring system will also be installed in the tent.

CT along with Stephen McCoy and Stephanie McCoy -our production managers- will be working with the Fire Department to assure that we comply with all fire regulations and requirements.

Water Supply and Sanitation:

CT will be using the current water and sanitation facilities of Sierra Nevada College. Signage will direct attendees to sanitation facilities.

The college campus exceeds the requirements for anticipated attendees.

Medical facilities and services:

Medical facilities will not be necessary this event.

Vehicle parking spaces:

275 parking spaces are available for event use at Sierra Nevada College. It was determined that this will be sufficient for the 400 event attendees.

Vehicle access and parking control:

See the attached site plan where vehicle access can be seen. Traffic control will be provided by at least two volunteers during each night of the event.

Communication system:

One microphone on stage can be utilized for attendees' announcements if necessary. Event director and designated event emergency team will have both cell and radio communication. There will be no amplification of music at this event.

Illuminating the premises:

All event activity will be over by 9:30pm, which will be the beginning of dusk during this time of the year. Event parking and path lighting is already installed at Sierra Nevada College. The tent and stage lighting will be provided by Sacramento Stage and Lighting.

Camping:

No camping will be allowed at this event

Clean-up and Rubbish removal:

Classical Tahoe Volunteers and Waste Management will be looking after the clean-up and rubbish removal. Waste Management provides two lockable trash containers with scheduled pick up.

Estimated cost: The total cost of Waste management for 2021 was \$1000. We estimate the same cost for 2022.

Rehearsal procedures

- Hand sanitizer will be available at all rehearsals
- masks and face shields will be distributed to all musicians (as requested) upon arrival for their use during their stay in incline (they will keep these items)
- all chairs and stands will be sanitized and wiped down in between rehearsals by musicians
- full sanitation and cleaning of the rehearsal space will happen between rehearsal days

Performance procedures

- while waiting for entrance into the venue all patrons will be health screened
- Classical Tahoe will follow all mask guidelines and mandates at the time of performances.
- all patrons will be spaced 3ft apart (excluding family units)
- once inside the venue, signage will direct patrons where to go. They will be escorted to their assigned seats by CT staff.
- Hand sanitizer will be available throughout the venue
- musicians will have a backstage waiting area with sanitizer
- restroom will be cleaned/sanitized throughout the event
- patrons will be asked to remain in their seats and to observe social distancing while at the event
- all equipment at the venue will be sanitized after each event, tablecloths will be changed and washed before each week of performances.
- Classical Tahoe will follow all CDC and State of Nevada/Washoe County health and safety guidelines that are set at the time of the event.

See Attached

**OUTDOOR COMMUNITY EVENT
AFFIDAVIT OF PROPERTY OWNERSHIP
and/or PERMISSION TO CONDUCT EVENT**

STATE OF NEVADA)
) ss:
COUNTY OF WASHOE)

I, Sue Johnson for SNU being duly sworn, depose, and say that I am an owner* of property involved in this outdoor community event and I do hereby:

(check appropriate box)

Affirm that I am an applicant for the below named proposed outdoor community event and also own the property or properties on which the event will be conducted

OR

Affirm that I give permission to the applicants for the below named proposed outdoor community event to conduct the event on the following property or properties which I own:

Assessor Parcel Number(s): 127-040-10

Proposed Outdoor Community Event: Classical Tahoe

Signed [Signature]

Subscribed and sworn to before me this 21 day of March, 2022

[Signature]
Notary Public in and for said county and state

My commission expires: July 8, 2025



*Owner refers to the following. Please mark the appropriate box.

- OWNER/JOINT OWNER
- CORPORATE OFFICER/PARTNER
- POWER OF ATTORNEY (Provide copy of Power of Attorney)
- AGENT (Notarized letter from property owner giving legal authority to agent)
- LETTER FROM GOVERNMENT AGENCY WITH STEWARDSHIP

**OUTDOOR COMMUNITY EVENT
STATEMENT OF ASSETS**

As of April 1, 2022

(Describe fully and indicate assets pledged)
(If additional space is required, attached supporting pages or documents)

Current Assets

Cash on hand	_____	\$ _____
Cash in safe deposit box	_____	\$ _____
Cash in	<u>Wells Fargo Bank NA, Incline Village Branch</u>	\$ <u>389,279.49</u>
	<small>Location of Box</small>	
	<small>Name, Bank and Branch</small>	
Cash in	_____	\$ _____
	<small>Name, Bank and Branch</small>	
Accounts and notes receivable (describe nature of receivable and when due)	_____	\$ _____
	_____	\$ _____
Other current assets	_____	\$ _____
	_____	\$ _____

Investments

Stocks, Bonds, etc (Market value) (If close held corporation, furnish current balance sheet)	_____	\$ _____
	_____	\$ _____
	_____	\$ _____
Investments, other than stocks and bonds	_____	\$ _____
	_____	\$ _____
	_____	\$ _____

Fixed assets

Real estate (Give location, description and fair value of each parcel)	_____	\$ _____
<u>Artwork (Book Basis)</u>	_____	\$ <u>5,000</u>
<u>Lighting</u>	_____	\$ <u>6273</u>
<u>Artwork (Tax Basis Adjustment)</u>	_____	\$ <u>-5000</u>

Other assets

Automobiles and other personal property	_____	\$ _____
	_____	\$ _____
	_____	\$ _____

Total Assets \$ 395,552

Stephanie McCoy
Print Name

Signature

4/1/22
Date

**OUTDOOR COMMUNITY EVENT
STATEMENT OF LIABILITIES**

As of April 1, 20 22

(Describe fully, indicate secured liabilities)
(If additional space is required, attached supporting pages or documents)

Current liabilities

Notes payable _____ \$ _____
Name, Bank and Branch

Due _____ How secured _____

Notes payable _____ \$ _____
Name, Bank and Branch

Due _____ How secured _____

Notes payable _____ \$ _____
Name, Bank and Branch

Due _____ How secured _____

Notes payable _____ \$ _____
Name, Bank and Branch

Due _____ How secured _____

Other notes payable (indicate name, address and how secured)

_____ \$ _____
_____ \$ _____

Accounts payable \$ _____

Liability for Federal Income Tax (delinquent) \$ _____

Provision for current year's Federal Income Tax \$ _____

Provisions for other current taxes \$ _____

Liability for other delinquent taxes \$ _____

Mortgages payable (List each mortgage separately, how secured, and monthly payments due thereon)
_____ \$ _____
_____ \$ _____

Other liabilities
_____ \$ _____
_____ \$ _____
_____ \$ _____

Total Liabilities \$ 0

Contingent liabilities (describe)

Stephanie McCoy
Print Name

[Signature]
Signature

4/1/22
Date

OUTDOOR COMMUNITY EVENT

PERSONAL HISTORY

(complete a separate form for each applicant, to include corporate officers and partners)

Name in full: Stephanie McCoy
First Middle Last

List ALL other names you have been known by: Stephanie McMullen, Williams

Residence address: [Redacted]
Street City State Zip Code

Residence phone: [Redacted] Business phone: 775-298-0245

Name of your present business or employer: Classical Tahoe

Business address: 948 Incline Way Incline Village, NV 89451
Street City State Zip Code

Type of business: Non-Profit Arts Position: Operations Director

How long engaged in this business: 8 years

Date of birth: [Redacted] Age: [Redacted] Place of birth: [Redacted]

List cities in which you have lived during the last ten years:

Dates From and To City State
2003 - Present Reno NV

I, the undersigned, have answered all questions in this application and to the best of my knowledge all answers are true and correct. I further understand that disclosure of any false, misleading or incorrect answers could result in the denial of the license. The filing of the application does not authorize the conducting of any event for which a license is required, and any carrying on of such event before a license is issued may also be grounds for denial of a license.

Stephanie McCoy
Printed name of applicant

[Signature]
Signature of applicant

4/1/22
Date

**OUTDOOR COMMUNITY EVENT
CONTRIBUTORS OR INVESTORS LIST**

(List the names and addresses of any person contributing, investing or
having an expected financial interest greater than \$500 in producing the event)
(attach additional sheets if needed)

Name

Address

See Attached Donor List

ANCILLARY SERVICES OR ACTIVITIES LIST

(List the names and addresses of any person expected to provide, for consideration,
services or activities ancillary to or in conjunction with the event)
(attach additional sheets if needed)

Name

Address

See Attached Musician Poster

**OUTDOOR COMMUNITY EVENT
RELEASE OF CLAIMS**

(complete a separate form for each applicant, to include corporate officers and partners)

The undersigned has filed with Washoe County Business License an application for outdoor community event license. In consideration of the assurance by the Board of County Commissioners that no vote on said application will be taken except after a deliberate, intensive and thorough investigation of the undersigned, including but not limited to criminal history background, associates and finances, the undersigned does for himself, his heirs, executors, administrators, successors and assigns, hereby release, remise and forever discharge the County of Washoe, Washoe County Sheriff's Office, Washoe County Commission, and Washoe County Business License from any and all manner of actions, causes of action, suits, debts, judgments, executions, claims, and demands whatsoever, known or unknown, in law or equity, which the undersigned ever had, now has or may have, or claim to have against any or all of said entities or individuals arising out of or by reason of the processing or investigation of or other action relating to the undersigned application.

AUTHORIZATION TO RELEASE INFORMATION

As an applicant for an outdoor community event license with Washoe County Business License, I am required to furnish information for use in determining my qualifications. In this connection, I authorize release of any and all information of a confidential or privileged nature.

I hereby release you, your organization and others from liability or damage, which may result from furnishing the information requested. This release will expire 180 days after the date signed.

I, the undersigned, have read this release and understand all its terms; I execute it voluntarily and with full knowledge of its significance.

IN WITNESS WHEREOF, I have executed this release at SPARKS, NEVADA on the 4th day of APRIL, 2022.

Stephanie McCoy
Printed name of applicant

[Signature]
Signature of applicant

Subscribed and sworn to before me this 4th day of APRIL, 2022

Baerbel A. Brown
Notary Public in and for said county and state

State of Nevada
County of Washoe
This instrument was acknowledged
by STEPHANIE on 4-4-2022
McCoy

My commission expires: NOV 13, 2022

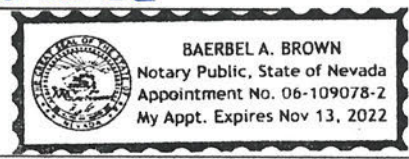

Classical Tahoe Officers and Board of Directors 2022

Officers and Executive Committee

Chair Marna Broida

President Renee Bouck

Secretary Susan Pridmore

Governance Leslie Whittman

Sustainability Madylon Meiling

Directors

Ron Ashley

Soraya Aquirre

Steven Bouck

Melanie Susan Broida

Caroline Kaplan

Victoria Kahn

Peter Garcia

Kimberly Garcia

Janet Pahl

Alvaro Pascotto

Linda Pascotto

Steven Stull

Ian Weiss

CLASSICAL TAHOE 2022

Orchestra roster as of 3/4/22

Musician/position Concerts email address

Violins:

Laura Hamilton, concertmaster 1-7+rec lhamilton415@gmail.com
Maria Schleuning, pr2 1-7+rec mariaviolin@sbcglobal.net
Zubaida Azezi, section 4-5 zubaida.azezi77@gmail.com
Gennady Filimonov, section 1-7+rec gennadyfilimonov@gmail.com
Annamae Goldstein, section 6-7+rec annamaegoldstein@gmail.com
Rachel Golub, section 1-7+rec rachelgolub@gmail.com
Erin Hall, section 6-7+rec missairn@bellsouth.net
Kristi Helberg, section 1-7+rec krevelyn@yahoo.com
Simon James, section 4-7+rec simon@simonjamesmusic.com
Daniel Khalikov, section 1-7+rec hahlikov@hotmail.com
Brian Krinke, section 1-7+rec brianlkrinke@gmail.com
Jeehae Lee, section 1-7+rec wwj247@gmail.com
Ruth Lenz, section 1-5 ruthlenz@yahoo.com
Laura Lutzke, section 1-7+rec lauralutzke@gmail.com
Yurika Mok, section 1-7+rec yurikamok@gmail.com
Catherine Sim, section 1,3,4,6,7+rec catjsim@aol.com
Kay Stern, section 1-7+rec kaystern@me.com
Sarah Vonsattel, section 1-5 sarahcrocker1@gmail.com
Sarah Vonsattel, soloist 2
Xiao-Dong Wang, section 2,5,6,7+rec wangxdviolin@gmail.com
Julian Maddox, CT Fellow 1-7 julian.maddox13@gmail.com
_____, CT Fellow 1-7

Violas:

Desiree Elsevier, principal 1-3 desiree@elsevier.com
Katie Kadarrauch, principal 4-5 KatieKadarrauch@gmail.com
Milan Milisavljevic, principal 6-7 +rec milan.mili@gmail.com
Sarah Adams, section 1-7+rec sarahmamavla@aol.com
Katarzyna Bryla-Weiss, section 1-7+rec katarzyna.bryla@gmail.com
Desiree Elsevier, section 4-7+rec desiree@elsevier.com
Scott Hosfeld, section 1-7+rec scotthosfeld@gmail.com
Catherine Ro, section 1-7+rec ro.catherine@gmail.com
Pedro Pablo Mendez, CT Fellow 1-7 pedropablomt0804@gmail.com

Celli:

Winona Zelenka, principal 1-7+rec winonazelenka@gmail.com
 Winona Zelenka, soloist 2
 David Calhoun, section 1-7+rec calhouncellist@gmail.com
 Lanny Paykin, section 1-7+rec paykincello@gmail.com
 Wendy Sutter, section 1-7+rec wsutter67@gmail.com
 Saeunn Thorsteinsdottir, section 4-7+rec Saeunn@gmail.com
 Mariko Wyrick, section 1-7+rec marikowyrick@icloud.com
 Clarissa Vieira, CT Fellow 1-7 clarissavieiracello@gmail.com

Bass:

Jeremy McCoy, principal 1-7+rec mccoy.jeremy@gmail.com
 Timothy Dilenschneider, section 1-7+rec timothydbass@gmail.com
 Ha Young Jung, section 4-7+rec kontrahayoung@gmail.com
 Daniel Krekeler, section 1-7+rec dkrekeler@gmail.com
 Chris Johnson, section 4-7 bassplayaplaya@gmail.com

Flute:

Erik Gratton, principal 1-7+rec erigire@bellsouth.net
 Erin James, 2nd/picc 1-7+rec ozgig@aol.com
 Sebastian Brea Perez, CT Fellow 4-7 sebastian.brea@interlochen.org

Oboe:

Nathan Hughes, principal 1-7+rec hughesoboe@gmail.com
 Nathan Hughes, soloist 2
 John Upton, 2nd/eng horn 1-7+rec uptonjt@gmail.com
 (In concert #2, John will play the Wagner and 1st oboe in Haydn)
 Aaron Hill, 2nd 2 (Haydn only) aaronhill@unr.edu
 Eduardo Sepulveda, CT Fellow 4-7 eduardoboe8@gmail.com

Clarinet:

Dan Gilbert, principal 1-7+rec hellodangilbert@gmail.com
 Ixi Chen, 2nd 1-7+rec ixichen@gmail.com
 Alisha Zamore, CT Fellow 4-7 + rec alishazamore@gmail.com
 (Alisha will play all bass clarinet parts, plus treble clarinet as required.)

Saxophone:

David Henderson 6-7+rec davidduaneh@gmail.com
 Kevin Stewart 7+rec kjstewart26@comcast.net
 Dale Wolford 7+rec dalewolford@gmail.com

Bassoon:

Whitney Crockett, principal 1-3, 6-7 rec whitbworth@gmail.com

Whitney Crockett, soloist 2

Evan Epifanio, principal 4-5 epifanio.bsn@gmail.com

Erik Holtje, 2nd 1-7 eholtje@aol.com

(In concert #2, Erik will play the Wagner and 1st bassoon in Haydn)

Samantha Duckworth, contra 6-7+rec whitbworth@gmail.com

(Samantha will play 2nd bassoon in Gershwin and Emporium, in addition to all contrabassoon parts.)

French Horn:

Stewart Rose, principal 1-5 stewrose@gmail.com

Thomas Jostlein, principal 6-7+rec jostlein@yahoo.com

Anne Marie Scharer, 2nd 1-7+rec anne.scharer@gmail.com

(Anne will play 3rd horn only in Tchaik Vln Concerto, concert 1)

Thomas Jostlein, 3rd 4-5 jostlein@yahoo.com

Tricia Jostlein, 4th 6-7+rec (Emporium only) Tricia_horn@yahoo.com

Patrick Pridemore, 4th 4-5 patpridemore@gmail.com

Patrick Pridemore, 3rd 6-7+rec

John Lenz, 2nd (Tchaik only) 1 johnglenz@gmail.com

Natalie Higgins, 4th (Tchaik only) 1 nhiggins@unr.edu

Nelson Yovera Perez, CT Fellow 4-7 nelsonyoveracorno@gmail.com

Mark Almond, guest 8/3 chamber (Brandenburg #1 1st horn) mhalmond@me.com

Trumpet:

Billy Hunter, principal 1-7+rec billyrayhunterjr@yahoo.com

b1812@hotmail.com (use both emails for Billy)

Adam Luftman, 2nd 1-3 adamluftman@gmail.com

Guy Piddington, 2nd 4-7+rec gpiddington@gmail.com

Adam Luftman, 3rd 6-7+rec adamluftman@gmail.com

Federico Montex, CT Fellow 4-7 federicomontesv@gmail.com

Trombone:

David Garcia, principal 4-7+rec dpgtbn@gmail.com

Denson Paul Pollard, 2nd 4-7+rec pp70@aol.com

Nicholas Schwartz, bass 4-7+rec nickschwartz@me.com

Harry Gonzalez, CT Fellow 4-7 harry.gonzalez55@gmail.com

Tuba:

Dan Peck 4-7+rec danjpeck@gmail.com

Timpani/Percussion:

Aaron McDonald, timp 1-7+rec aaronsmcd@gmail.com

Steven White, principal perc 4-7+rec sdwhite20@gmail.com

Matthew Ward, section perc 4-7+rec mwardpercussion@gmail.com

Dana Dominguez, CT Fellow 4-7+rec dmd9@rice.edu

Harp:

Marina Oster, principal 1,4,6,7 marinaharp@gmail.com

Banjo:

John Imholz rec only johnimholzch@gmail.com

Keyboards:

Donna Lee 7 (celesta) + 7/31 and 8/3 chamber donnalee04@gmail.com

Anna Stoytcheva 6 (pno&celesta) + 7/31 chamber annastoytcheva@yahoo.com

Dongsok Shin, harpsichord 8/2 chamber dongsokshin@gmail.com

italics indicate musicians who have not yet confirmed

Classical Tahoe Donor List

Classical Tahoe is made possible, in part, through a generous donation from the following:

Carol Franc Buck Foundation

founder

\$10,000 and above

Anonymous
Julia Amaral and Mark Strate
Carole Anderson
Maureen and Ron Ashley
Bently Foundation
Marna Broida*
Renee and Steve Bouck*
Carol Franc Buck Foundation
Elaine Cardinale and Jonathan Knowles
Confidence Foundation
Anne and Roger H. Forbes
FS Foundation
Jerome Guillen and Jeremy Gallaher
Florence and Steven Goldby
Holland & Hart
Carol and Douglas Koelemay
Dennis and Alexandra Landis
Anh-Tuyet Nguyen and Robert Pollock
Madylon and Dean Meiling*
Linda and Alvaro Pascotto*
Greg and Patty Raleigh
Laurie and Silvio Ricardi
The Spirit Burns Fund
Ian Weiss
Roma Wittcoff*
Leslie Wittmann and Michael Blaszyk
Whittier Trust
Monica Young

supporter

\$5,000 – \$9,999

Anonymous
Soraya and Jose Aguirre
Ashley Quinn, CPAs and Consultants, Ltd.
Estel and Wally Binder
Victoria Kahn and Josh Bartic
Ann Graham Ehringer
Jerome Guillen & Jeremy Gallaher
Peter and Kimberly Garcia
Silvia Johnson
Victoria Kahn and Joshua Baltic
Brian and Nancy Kennedy
Sara and Leonard Lafrance
Grace & Shinn Lee
Charlotte and Dick McConnell
Steven Nightingale
Janet Pahl Coldwell Banker Select Real Estate
Susan Pridmore and Dr. Myles Riner
Kern Schumacher
Christine and John E. Sells, Sells Foundation
Claire and Steven Stull
Marietta Wu and Thomas Yamamoto

music lover

\$1,000 – \$4,999

Cynthia and Dr. Ronald Allison
Anonymous
Bob August
Ina and Steven Bauman*
Cynthia Calderon
Denise Cashman
Susan Clemons
Larry and Sandy Cohan
Karen and Lindsay Craig*
Iljosa and Clifford Dobler
William Douglass
Joan Duffield
Enderby Family in honor of Zach Lahrache
Jackie and Don Feinstein
Cathy and Ed Filusch*
Sally and Jerry Flanzer

Barbara and Ron Goldman
Barbara and Fred Ilfeld
Randall Fleisher
Caroline and Jim Kaplan
Margo and Atam Lalchandani
Sevim Larsen
Grace Lee
Wendell Maddox
Tom and Margaret Mallon
Kathleen Marrone
Dorothy and John McDonald
Kathleen McDonald
Kyungae Bae and Ralph Miller
Janet Napolitano*
Rafael and Marina Pastor
Cindy Rhys*
Suzanne Simon
Al Smith
Carolyn Tolf
Alexander, James and Stephanie Watters
Helen Tropp-Zell and Jerrold Zell

friend

up to \$999

AAA
Cecilia Aceti
Patricia Ackerman
Sheila Aharoni
DeLores and Dave Aiazzi
Don and Dory Albert and Family
Joe Almasy
David Anderson
Marie Andrus
Alana Apfel
Juliet Ashton
Anonymous
Lori and Steve Bard
Leslie Bateman
Cindy Behmer
Alice Blair

Maryam Broome
Tish and Chris Brubeck
Diane Brumbaugh
Susan Carbiener
Loretta Clarke
Classical Tahoe Orchestra Tahoe Percussion/Timpani Section: Aaron McDonald, Matt
Ward, Steven White*
Tiffany Clements
Sandy and Larry Cohan
Tracy Cohn
Ginger Coltrin
Shawn Considine
Gloria Cote
Gwen Davis-Toso*
Catherine Derr
Breanna De Geere
Kathy and Frank Dilenschneider*
Frances Donohue-Fisher
Karen Doughty
Barbara Draheim
Anne Dreschler
Heather Dunning
Gisela Duvigneau
Margaret Eaddington
Katharine Page Eccles
Robert Ecke
Ainin Edman
Regina Edwards
Ron Erikson
John Feliz
Sharon Fiehler
Hilary and Daniel Fylstra
Marilyn Gaddis
Babette Galinak
Elyce Gall
Timothy Geckle
Sande Gendel
Donna Lee and Daniel Gilbert
Deborah Gleeson
Kristine Gloviak
Kathy Komaroff Goodman

Kerry Grana
Mark Greenberg
Lee Hansen
Cindy Harris
Sam Harrosh
Thomas Hatch
Dr. Dabney Hart
Monica Haver
Melissa Hereford
Nicholas Hinkell
Jane Johnson
Elita Kahn
Mark Kahn
Deena Karuna
Raj Karwa
Veronica Kaufman
Anne Kaplan
Stephanie Katz
Ryan Kerrigan
Norma and Kwang Kim*
David Kladney*
Robert Kline
Camille Knopf
Renee Kreamer
Terry and Bill Krivan
Dianne Lange
Marian Leary
Joan Le Coq
Ann Lee
Eric Lovejoy
Larry Ludwig
Linda Lynch
Julia Maddox
Carolyn Mahboubi
Gail Marshall
Leslie Matkosky
Garrett Meinke
Charles Meyer
Jeremy McCoy*
Stephanie and Steve McCoy*
Sharon McDougall

Mari McEneny
Denise Miller
Dotty Molt
Tina Montoya
Tege and John Montmorrency
Angela Moore
Bruce Morgan
Richard Morley
Micki Napp
Ananth Natarajan
Thomas Nawrocki
Kristin Nelson
Antonia Neubauer
Miho Ogawa
Nora Oliver
Mr & Mrs Mark Osberg
Anna Pagliughi
Laura Hamilton and Lanny Paykin*
Lisa Peat
Mary Megan Peer
Peter and Cynthia Perretti
Rosalind Plishner
Paul Pooley
Heather Prella
Jacqueline Richmond
Barbara Ricotta
Thalia Routsis
Martha Russell
Natalie Rumao
June Safran
Margaret Scheirman
Janet Schleimer
Deborah Scott
Lynne Shapiro
Barbara Steinberg
Rachel Stengel
Kay Stern
Katie Stevenson
Martin Strauss
DeJuan Stroud
J.J. Stupp

Joan Sublett
Shoshana Tancer
Alex Tsigdinos
Susan Underwood
Dr. Janet Usinger
Rob and Veronica Valli
Debra and Jaap Van Opstal
Tom Vann
Jean Varden
Martha Voss
Linda Brinkley & Ronald Randolph Wall
Rita Warren
Shireen Piramoon and Bill Watson
Amanda Wiebush
Marcia Wittmann
Dr. Meryl Brod and Len Weiss
Charlotte Welco
Anne and David Wells
Carrie Wells
Jeffrey Wells*
Kendra Wong
Kathy Woolston
Pam and Charley Yandell
Stuart Yount
Winona Zelenka
Kim Zwick

**OUTDOOR COMMUNITY EVENT
INSURANCE, HOLD HARMLESS AND INDEMNIFICATION REQUIREMENTS**

Pursuant to Washoe County Code section 25.303, any applicant for a Washoe County outdoor community event license must ensure the following requirements are met to the satisfaction of the Washoe County Risk Management Division before the outdoor community event license may be issued.

INDEMNIFICATION & HOLD HARMLESS

As respects acts, errors or omissions relating to the event, APPLICANT agrees to indemnify and hold harmless COUNTY, its officers, agents, employees, and volunteers from and against any and all claims, demands, defense costs, liability or consequential damages of any kind or nature arising directly or indirectly out of the event or any activity leading up to, during, or following the event, excepting those which arise out of the sole negligence of the COUNTY.

APPLICANT further agrees to defend COUNTY and assume all costs, expenses and liabilities of any nature to which COUNTY may be subjected as a result of any claim, demand, action or cause of action arising out of the negligent acts, errors or omissions of APPLICANT or its agents concerning the event.

INSURANCE REQUIREMENTS

COUNTY requires that APPLICANT purchase General Liability Insurance as described below against claims for injuries to persons or damages to property which may arise from or in connection with the event by APPLICANT, its agents, representatives, or employees. The cost of all such insurance shall be borne by APPLICANT.

APPLICANT shall maintain coverage and limits no less than \$1,000,000 combined single limit per occurrence for bodily injury, personal injury and property damage. If Commercial General Liability Insurance or other form with a general aggregate limit is used, the general aggregate limit shall be increased to equal twice the required occurrence limit, to apply separately to this event.

Any deductibles or self-insured retentions must be declared to and approved by the COUNTY Risk Management Division prior to the event. COUNTY reserves the right to request additional documentation, financial or otherwise prior to giving its approval of the deductibles and self-insured retention and prior to issuing the license. The COUNTY Risk Manager prior to the change taking effect must approve any changes to the deductibles or self-insured retentions.

APPLICANT shall provide COUNTY with a certificate of insurance that identifies COUNTY, its officers, agents, employees and volunteers as additional insured's.

NOTE: A certificate of insurance complying with the provisions stated above is not required with the outdoor community business license application, but must be furnished prior to the issuance of the license.

I hereby agree to the all of the provisions stated above:

Classical Tahoe _____ July 14 - Aug 6 _____
Name of Event Date(s) of Event

Stephanie McCoy _____ [Signature] _____
Applicant's name (printed) Applicant's signature

Date: 4/1/22 _____

Festival location

12-1271

PROJECT AREA
 DRAINAGE CALCULATIONS

PROJECT AREA: 1000000 SQ. FT. (APPROX.)
 PERCENT IMPERVIOUS: 10%
 PERCENT PAVED: 5%
 PERCENT ROADS: 5%

ADJUSTED IMPERVIOUS COEFFICIENT: 0.095
 ADJUSTED PAVED COEFFICIENT: 0.0475
 ADJUSTED ROADS COEFFICIENT: 0.0475

TOTAL IMPERVIOUS AREA: 1000000 SQ. FT.
 TOTAL PAVED AREA: 50000000 SQ. FT.
 TOTAL ROADS AREA: 50000000 SQ. FT.

OFFICE COPY

SIERRA NEVADA COLLEGE
 LAKE CAMPUS & WEST-SIDE
 INCLINE VILLAGE
 WARDEN COUNTY, NEVADA

SCALE: 1"=50'

SHEET 1 OF 1

TABLE

NO.	DESCRIPTION	DATE
1	DESIGNED BY	
2	CHECKED BY	
3	APPROVED BY	
4	DATE	



A.P.N. 127-040-18
 DRAINAGE CALCULATIONS

PROJECT AREA: 1000000 SQ. FT. (APPROX.)
 PERCENT IMPERVIOUS: 10%
 PERCENT PAVED: 5%
 PERCENT ROADS: 5%

ADJUSTED IMPERVIOUS COEFFICIENT: 0.095
 ADJUSTED PAVED COEFFICIENT: 0.0475
 ADJUSTED ROADS COEFFICIENT: 0.0475

TOTAL IMPERVIOUS AREA: 1000000 SQ. FT.
 TOTAL PAVED AREA: 50000000 SQ. FT.
 TOTAL ROADS AREA: 50000000 SQ. FT.

A.P.N. 127-040-08
 DRAINAGE CALCULATIONS

PROJECT AREA: 1000000 SQ. FT. (APPROX.)
 PERCENT IMPERVIOUS: 10%
 PERCENT PAVED: 5%
 PERCENT ROADS: 5%

ADJUSTED IMPERVIOUS COEFFICIENT: 0.095
 ADJUSTED PAVED COEFFICIENT: 0.0475
 ADJUSTED ROADS COEFFICIENT: 0.0475

TOTAL IMPERVIOUS AREA: 1000000 SQ. FT.
 TOTAL PAVED AREA: 50000000 SQ. FT.
 TOTAL ROADS AREA: 50000000 SQ. FT.

A.P.N. 127-040-04
 DRAINAGE CALCULATIONS

PROJECT AREA: 1000000 SQ. FT. (APPROX.)
 PERCENT IMPERVIOUS: 10%
 PERCENT PAVED: 5%
 PERCENT ROADS: 5%

ADJUSTED IMPERVIOUS COEFFICIENT: 0.095
 ADJUSTED PAVED COEFFICIENT: 0.0475
 ADJUSTED ROADS COEFFICIENT: 0.0475

TOTAL IMPERVIOUS AREA: 1000000 SQ. FT.
 TOTAL PAVED AREA: 50000000 SQ. FT.
 TOTAL ROADS AREA: 50000000 SQ. FT.

A.P.N. 127-040-04
 DRAINAGE CALCULATIONS

PROJECT AREA: 1000000 SQ. FT. (APPROX.)
 PERCENT IMPERVIOUS: 10%
 PERCENT PAVED: 5%
 PERCENT ROADS: 5%

ADJUSTED IMPERVIOUS COEFFICIENT: 0.095
 ADJUSTED PAVED COEFFICIENT: 0.0475
 ADJUSTED ROADS COEFFICIENT: 0.0475

TOTAL IMPERVIOUS AREA: 1000000 SQ. FT.
 TOTAL PAVED AREA: 50000000 SQ. FT.
 TOTAL ROADS AREA: 50000000 SQ. FT.

1. THE INFORMATION CONTAINED HEREIN IS FOR INFORMATIONAL PURPOSES ONLY AND IS NOT TO BE USED FOR ANY OTHER PURPOSE.

2. THE INFORMATION CONTAINED HEREIN IS THE PROPERTY OF THE ENGINEER AND IS NOT TO BE REPRODUCED OR TRANSMITTED IN ANY FORM OR BY ANY MEANS, ELECTRONIC OR MECHANICAL, INCLUDING PHOTOCOPYING, RECORDING, OR BY ANY INFORMATION STORAGE AND RETRIEVAL SYSTEM, WITHOUT THE WRITTEN PERMISSION OF THE ENGINEER.

3. THE INFORMATION CONTAINED HEREIN IS NOT TO BE USED FOR ANY PURPOSE OTHER THAN THAT FOR WHICH IT WAS PREPARED.

4. THE INFORMATION CONTAINED HEREIN IS NOT TO BE USED FOR ANY PURPOSE OTHER THAN THAT FOR WHICH IT WAS PREPARED.

5. THE INFORMATION CONTAINED HEREIN IS NOT TO BE USED FOR ANY PURPOSE OTHER THAN THAT FOR WHICH IT WAS PREPARED.

6. THE INFORMATION CONTAINED HEREIN IS NOT TO BE USED FOR ANY PURPOSE OTHER THAN THAT FOR WHICH IT WAS PREPARED.

7. THE INFORMATION CONTAINED HEREIN IS NOT TO BE USED FOR ANY PURPOSE OTHER THAN THAT FOR WHICH IT WAS PREPARED.

8. THE INFORMATION CONTAINED HEREIN IS NOT TO BE USED FOR ANY PURPOSE OTHER THAN THAT FOR WHICH IT WAS PREPARED.

9. THE INFORMATION CONTAINED HEREIN IS NOT TO BE USED FOR ANY PURPOSE OTHER THAN THAT FOR WHICH IT WAS PREPARED.

10. THE INFORMATION CONTAINED HEREIN IS NOT TO BE USED FOR ANY PURPOSE OTHER THAN THAT FOR WHICH IT WAS PREPARED.



090905



BARBARA K. CEGAVSKE
Secretary of State
202 North Carson Street
Carson City, Nevada 89701-4201
(775) 684-5708
Website: www.nvsos.gov

Filed in the office of <i>Barbara K. Cegavske</i> Barbara K. Cegavske Secretary of State State of Nevada	Document Number 20170371554-15
	Filing Date and Time 08/29/2017 8:58 AM
	Entity Number E0369612011-4

**Nonprofit Amendment
(After First Meeting)**
(PURSUANT TO NRS CHAPTERS 81 AND 82)

USE BLACK INK ONLY - DO NOT HIGHLIGHT

ABOVE SPACE IS FOR OFFICE USE ONLY

Certificate of Amendment to Articles of Incorporation
For Nonprofit Corporations
(Pursuant to NRS Chapters 81 and 82 - After First Meeting of Directors)

1. Name of corporation:

LAKE TAHOE SUMMERFEST

2. The articles have been amended as follows: (provide article numbers, if available)

The name of the organization should be changed to Classical Dance.

3. The directors (or trustees) and the members, if any, and such other persons or public officers, if any, as may be required by the articles, have approved the amendment. The vote by which the amendment was adopted by the directors and members, if any, is as follows: *

Vote of Directors: Vote of Members:

4. Effective date and time of filing: (optional) Date: _____ Time: _____
(must not be later than 90 days after the certificate is filed)

5. Signature: (required)

X *Beth Dennis*
Signature of Officer

Secretary
Title

* A majority of a quorum of the voting power of the members, or as may be required by the articles, must vote in favor of the amendment. If any proposed amendment would alter or change any preference or any relative or other right given to any class of members, then the amendment must be approved by the vote, in addition to the affirmative vote otherwise required, of the holders of a majority of a quorum of the voting power of each class of members affected by the amendment regardless of limitations or restrictions on their voting power. An amendment pursuant to NRS 81.210 requires approval by a vote of 2/3 of the members.

FILING FEE: \$50.00

IMPORTANT: Failure to include any of the above information and submit with the proper fees may cause this filing to be rejected.

This form must be accompanied by appropriate fees.

Nevada Secretary of State Amend Nonprofit -After
Revised: 1-5-15